

Weight: approx. 1.5 kg  
 Inertia: 2.14 kg · cm<sup>3</sup>

Voltage		Output power	Speed	Torque	Current	Stall torque	Stall current	Max. stall torque	Max. stall current	Back-EMF constant	Torque constant
		P	n	M	I	M <sub>o</sub>	I <sub>o</sub>	M <sub>omax</sub>	I <sub>omax</sub>	K <sub>e</sub>	K <sub>t</sub>
		kW	min <sup>-1</sup>	Nm	A	Nm	A	Nm	A	V/1000min <sup>-1</sup>	Nm/A
<b>24 VDC</b>	<i>Self cooling</i>	0.12	1500	0.75	6.5	1.10	9.1	4.5	37.4	8.0	0.13
		0.16	2000	0.75	9.4	1.10	12.6	3.5	40.1	5.8	0.10
		0.22	3000	0.70	13.0	1.00	17.1	2.2	37.5	3.9	0.06
	<i>External ventilation</i>	0.14	1500	0.90	8.1	1.25	10.3	4.5	38.1	8.1	0.13
		0.18	2000	0.85	10.5	1.25	14.1	3.5	38.5	5.9	0.10
		0.27	3000	0.85	15.4	1.15	19.1	2.2	34.6	4.0	0.07
<b>36 VDC</b>	<i>Self cooling</i>	0.12	1500	0.75	4.5	1.10	6.1	4.5	24.9	12.0	0.20
		0.16	2000	0.75	6.0	1.10	8.0	3.5	25.6	9.1	0.15
		0.22	3000	0.70	8.9	1.00	11.7	2.2	25.7	5.7	0.09
	<i>External ventilation</i>	0.14	1500	0.90	5.4	1.25	6.9	4.5	24.9	12.0	0.20
		0.18	2000	0.85	6.8	1.25	9.1	3.5	25.6	9.1	0.15
		0.27	3000	0.85	11.0	1.15	13.7	2.2	26.1	5.6	0.09
<b>48 VDC</b>	<i>Self cooling</i>	0.12	1500	0.75	3.5	1.10	4.7	4.5	19.3	15.5	0.26
		0.16	2000	0.75	4.6	1.10	6.1	3.5	19.6	11.9	0.20
		0.22	3000	0.70	6.3	1.00	8.3	2.2	18.3	8.0	0.13
	<i>External ventilation</i>	0.14	1500	0.90	4.2	1.25	5.4	4.5	19.3	15.5	0.26
		0.18	2000	0.85	5.2	1.25	7.0	3.5	19.6	11.9	0.20
		0.27	3000	0.85	7.8	1.15	9.7	2.2	18.5	7.9	0.13
<b>96 VDC</b>	<i>Self cooling</i>	0.11	1500	0.70	1.9	1.05	2.6	4.5	11.1	27.0	0.45
		0.15	2000	0.70	2.0	1.05	2.8	3.5	9.3	25.0	0.41
		0.20	3000	0.65	2.8	0.95	3.7	2.2	8.6	17.0	0.28
	<i>External ventilation</i>	0.13	1500	0.85	2.1	1.15	2.5	4.5	10.0	30.0	0.50
		0.18	2000	0.85	2.5	1.15	3.1	3.5	9.3	25.0	0.41
		0.25	3000	0.80	3.4	1.05	4.1	2.2	8.6	17.0	0.21
<b>150 VDC</b>	<i>Self cooling</i>	0.11	1500	0.70	1.7	1.10	2.4	4.5	10.0	30.0	0.50
		0.15	2000	0.70	1.7	1.10	2.4	3.5	7.8	30.0	0.50
		0.20	3000	0.70	1.7	1.00	2.2	2.2	4.9	30.0	0.50
	<i>External ventilation</i>	0.13	1500	0.85	2.1	1.15	2.5	4.5	10.0	30.0	0.50
		0.18	2000	0.85	2.1	1.15	2.5	3.5	7.8	30.0	0.50
		0.25	3000	0.85	2.1	1.05	2.3	2.2	4.9	30.0	0.50
<b>330 VDC</b>	<i>Self cooling</i>	0.11	1500	0.70	1.7	1.10	2.4	4.5	10.0	30.0	0.50
		0.15	2000	0.70	1.7	1.10	2.4	3.5	7.8	30.0	0.50
		0.20	3000	0.70	1.7	1.00	2.2	2.2	4.9	30.0	0.50
	<i>External ventilation</i>	0.13	1500	0.85	2.1	1.15	2.5	4.5	10.0	30.0	0.50
		0.18	2000	0.85	2.1	1.15	2.5	3.5	7.8	30.0	0.50
		0.25	3000	0.85	2.1	1.05	2.3	2.2	4.9	30.0	0.50

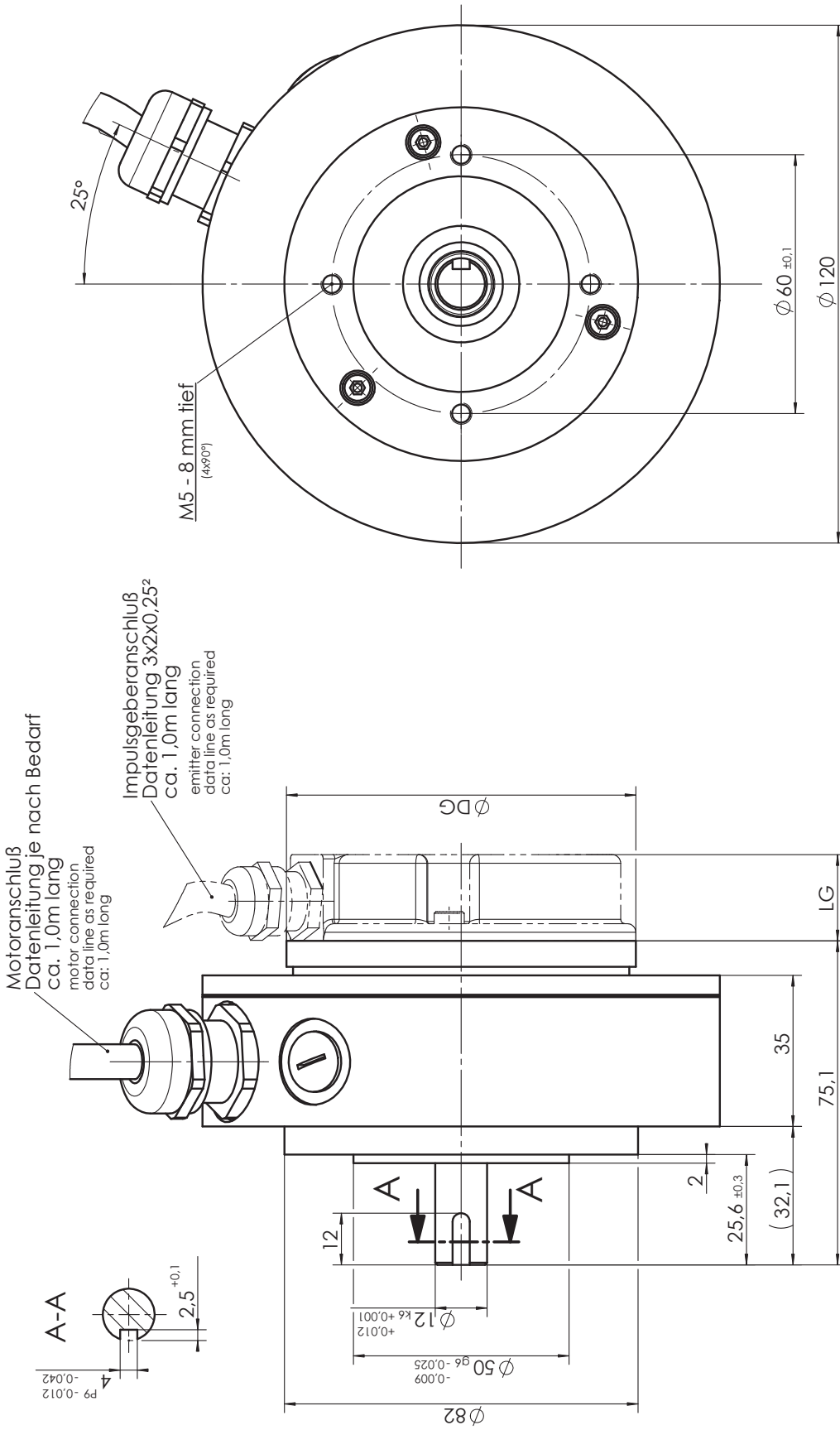

alle Motorausführungen for any type	ØDG	LG
Gebergehäuse mit Kabelauführung (Standard) pick-up with cable glands (standard)	81	20
Gebergehäuse mit Steckverbinder pick-up with connector	93	30
Motorvariante mit Hallensoren types with Hall probe	0	0